

DECT handset adapter 3.5 mm to 2.5 mm adapter

For further information | Für weitere Informationen
Pour plus d'informations | Para más información
Yderligere information



For support go to
www.sennheiser.com/cco/support

Sennheiser Communications A/S
Industriparken 27, DK-2750 Ballerup, Denmark
www.sennheiser.com | Printed in China, Publ. 06/15, A01

Connecting to a wireless handset and/or PC

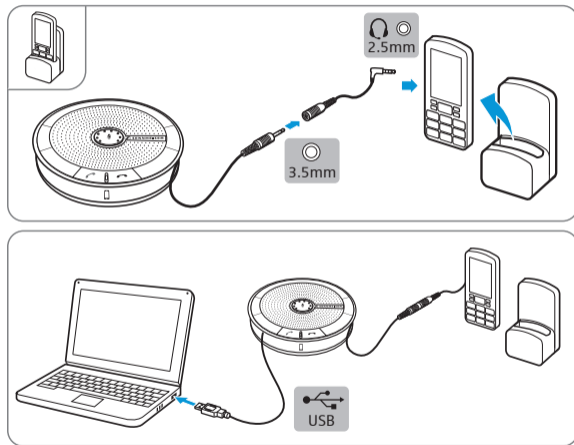

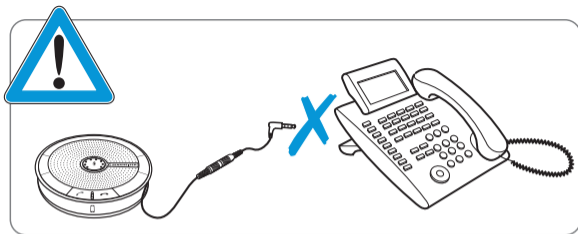

EN Potential for ground loop interference.
Not approved for wired deskphone use.



DE Gefahr von Störeinflüssen und Erdschleifen. Nicht für die
Verwendung mit kabelgebundenen Bürotelefonen geeignet.



FR Danger de perturbations et de boucles de masse. Ne convient
pas à une utilisation avec des téléphones filaires de bureau.

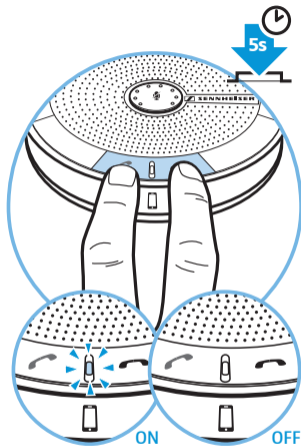

ES Peligro de interferencias y de lazos de tierra.
No adecuado para el uso con teléfonos de oficina con cable.



DA Risiko for stel sløjfe.
Ikke godkendt for trådede bordtelefoner



EN If the speakerphone does not turn
on/off automatically:
Press and hold the  and  button

DE Wenn sich das Speakerphone nicht
automatisch ein-/ausschaltet:
Drücken und halten Sie
die Tasten  und 

FR Si le haut-parleur ne s'allume/s'éteint
pas automatiquement :
Appuyez sur les touches
 et  et maintenez-les enfoncées.

ES Si el altavoz manos libres no se
enciende/apaga automáticamente:
Pulse y mantenga pulsadas
las teclas  e 

DA Hvis speakerphone ikke
tænder/slukker automatisk
tryk og hold på  og 